

ITAMA 55 FT YEAR 2010

TOTAL Ft 61.75/ 18.82 Meters



ITAMA 55: THE EPITOMY OF ELEGANCE

Known for their exceptional performance, timeless style for over 40 years, ITAMA made the history of Italian open yachts all over the World. Today part of the Ferretti Group, still bearing her distinctive identity at the heart of which lie outstanding engineering, performance and efficiency, The ITAMA 55 has kept the original brand's spirit, it's unique incomparable style, proudly illustrating the quote:

“ A solid past for a brilliant future”

She is quite the epitomy of elegance! Her breathtaking lines, elongated bow, luxurious interiors, spacious cabins, superb overall silhouette and outstanding cruising performance, will astound you.

EXTERIOR DECK Sun Pads & Exterior Salon



EXTERIOR DECK (cont.)



BOW



INTERIOR SALON



GALLEY



MASTER CABIN



VIP CABIN



GUEST TWIN CABINS



LAYOUT

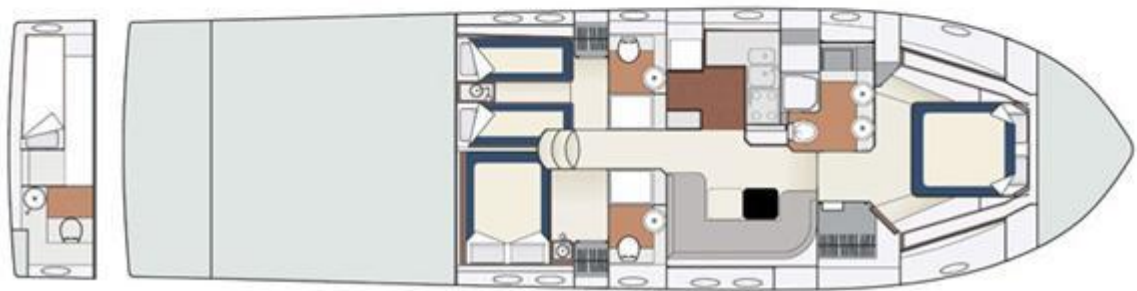
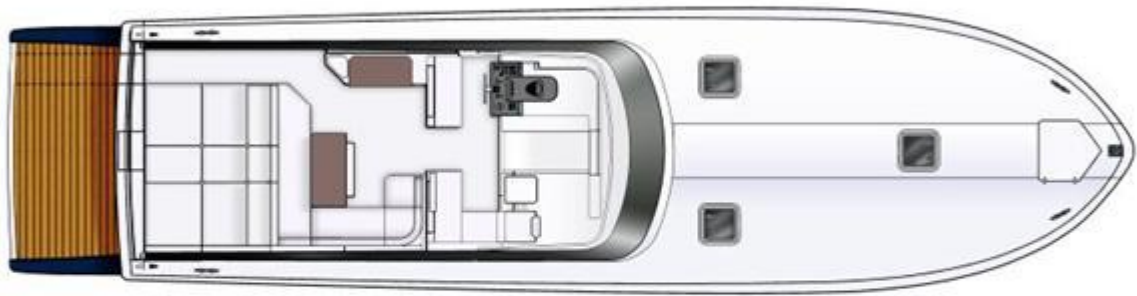

ACCOMODATIONS

&

Features

Length: 18.82 Meters / 61,75 Ft

Beam: 4,75 Meters

Draft: 1,71 Meters

Displacement: 28,30 Tons

Fuel: 3250 Liters

Water: 700 Liters

Engines: 2 x 1300 Man

Accommodation: Sleeps Pax 6

Cabins: 3

Master Cabin, VIP Cabin, and Guest Cabin all with en-suite WC.

Other: Air condition, Washing Machine Kitchen, Sono System, TV in Salon, I Pod Compatible, Ice Maker, Microwave ceramic Stove

Water Sports: Sub Wing and Tubes.

Tender: Zodiac Outboard 20 HP.

FEATURES

Above deck : The Itama 55 is quite simply the epitome of elegance. Her breathtaking lines, elongated bow and streamlined, smoked windshield are superb and the overall silhouette is so smooth that at first sight the access to the fore sundeck seems invisible. At the stern, the impressive teak bathing platform on hydraulic jacks can be used to effortlessly launch a tender with access from the platform to the cockpit passing by a large sundeck to starboard. In the center of the cockpit lies an on-deck saloon facing a small galley. The helm station is well positioned behind the windshield, with two bench seats on either side of the boat and a magnificent dashboard at once futuristic and retro, and a beautifully designed helm.

Below Deck : The Itama 55 may be beautiful on the outside, she is none the less stunning below deck. A successful combination of light and dark woods, chrome and stainless steel creates a highly contemporary feel and the impeccable finishings give a kind of understated elegance and efficiency. The master cabin is in the bow, with the guest cabins in the centre of the boat on either side of the companion way : a double berth to starboard and the twin berths to port. Each cabin has its own bathroom. In between the guest cabins and the owner's cabin is a well-designed and nicely equipped galley and a large saloon.

GALLERY

