

EVO MARINE 76 FT FLY BRIDGE (2007)



Picture Gallery

















Main Deck



Lower Deck

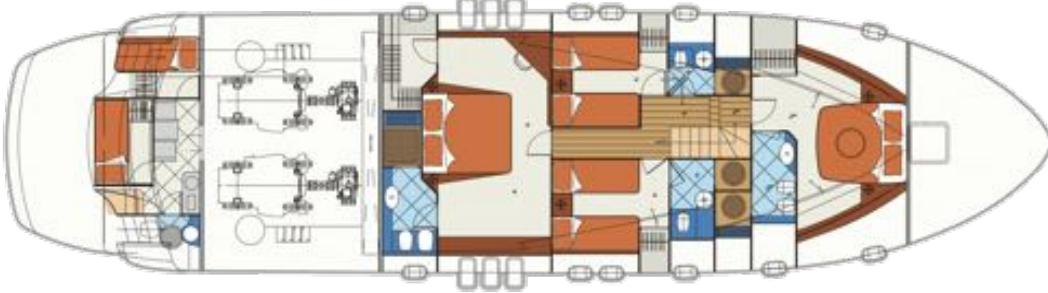

She accommodates up to eight guests in four staterooms. She is a modern designed yacht inside and out, still in production by Filippetti Yachts, designed by Fulvio de Simoni.

The cabins, two doubles and two twins, convertible upon request into doubles, are all very spacious with the bathrooms en suite all outfitted with modern fixtures and showers. The Master cabin is amidships on full width with a separate wardrobe, while the VIP is in the fore. The twins are identical with one twin having a bathroom with door which opens to the hall in case guests prefer that for day head. All cabins have TVs, CD players and telephones, all fully air-conditioned.

The sitting and dining room are spacious in modern design with Bang & Olufsen TV and HiFi, Playstation 3 wine cooler, fully air-conditioned. The kitchen is fully equipped while the aft deck of the boat is spacious with a large dining table, having easy access to the water with a twin staircase descending to the sea. The upper Sun Deck has a wonderful spacious area for relaxing in the shade under her expansive canopy, sunning on the mattress fore of the upper bridge or dining at her table. There is a BBQ for dinners or lunches when anchored, while at the bow there is another dining table, with expansive canopy, easily converted into sun bed.